



Visitor Guide

NEW BEDFORD WHALING MUSEUM



18 Johnny Cake Hill, New Bedford, MA 02740 | 508-997-0046 | www.whalingmuseum.org

Level

4

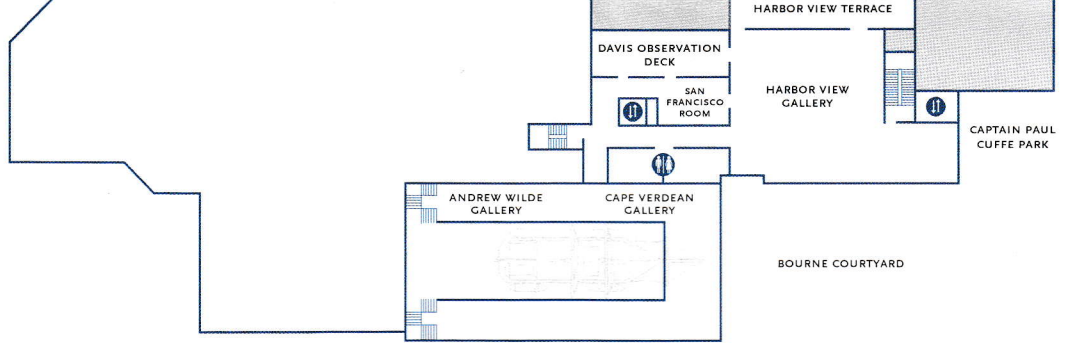

Level

3

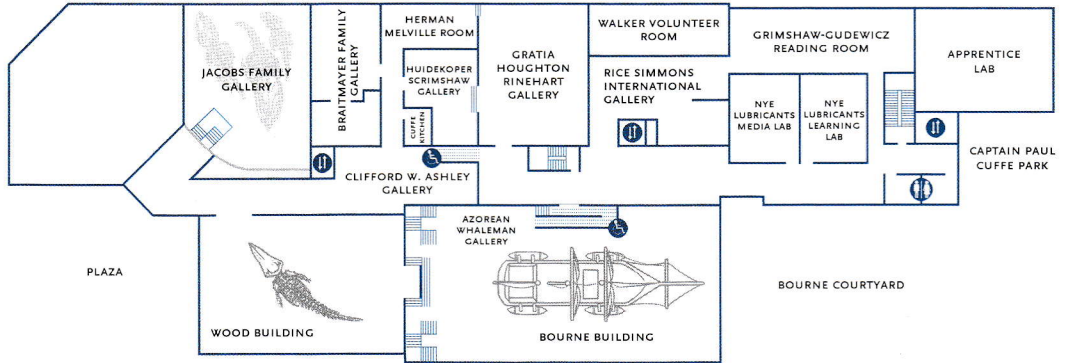

Level

2

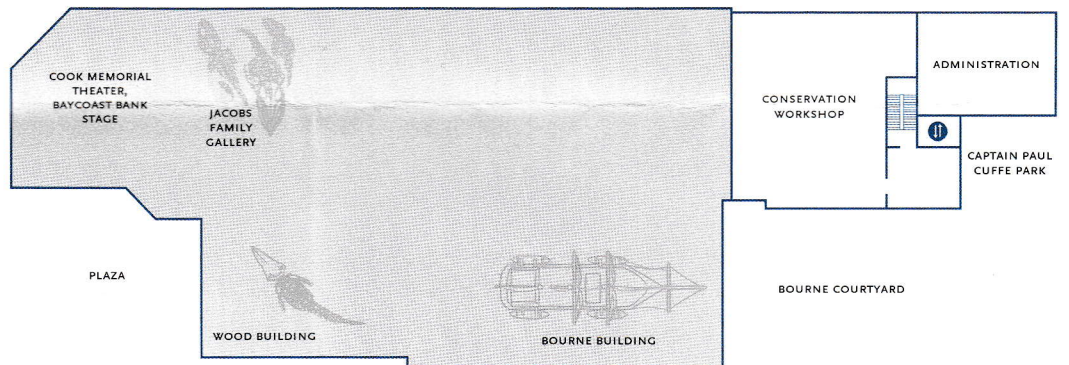

Level

1

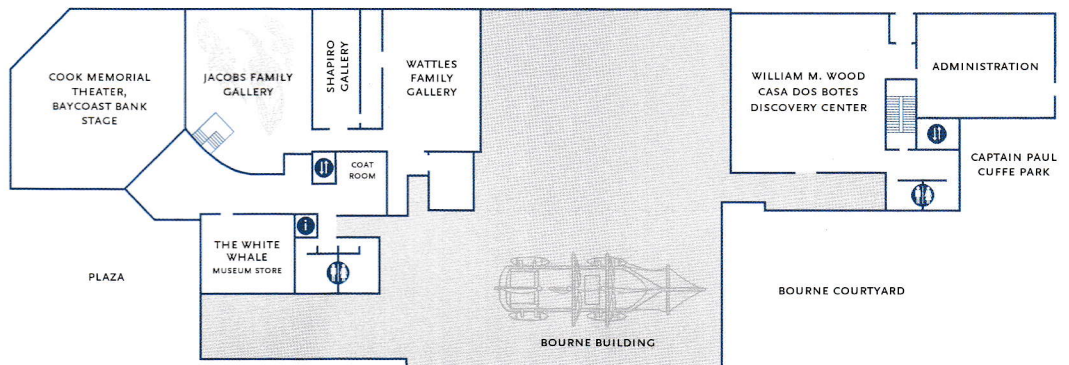

Information



Restrooms



Visitor Services



Elevator



Ramp



Museum Hours

April – December

Daily 9:00 a.m. to 5:00 p.m.

Until 8:00 p.m. every second Thursday of the month

January – March

Tuesday – Saturday 9:00 a.m. to 4:00 p.m.

Sunday 11:00 – 4:00 p.m. | Open on Holiday Mondays

Until 8:00 p.m. every second Thursday of the month

Closed Thanksgiving, Christmas, and New Year's Day



Museum Policy

- Children under 14 years must be accompanied by an adult.
- No backpacks, packages, oversized bags or umbrellas in the Museum. Lockers are provided near the admissions desk.
- Food is only allowed in the Jacobs Family Gallery, adjacent to the Museum Lobby.
- Bags over a certain size are subject to search upon entrance and exit.
- Shirts and shoes are required.
- Turn cellphones off (or to silent mode) while in the Museum & Theater. Please refrain from using cellphones in the galleries.

Photo/Video Policy

- Photographs and moving pictures (without flash or tripod) are permitted for private non-commercial use except where the “no photo” icon is displayed .
- Objects on loan from private collections or other institutions may not be photographed or filmed.
- The Museum reserves the right, at its sole discretion, to withhold and/or withdraw permission to photograph or film on its premises.
- Members of the press or film industry must contact the Marketing Department.

Functions and Rentals

The Museum offers several unique settings for weddings, corporate, and social events. Contact: specialevents@whalingmuseum.org